

C4-MU

EXPRESSDRY GEAR DRYERS

Maximum Number of Gear Sets	4
Crated Weight <i>lbs (kg)</i>	345 (157)
Machine Width <i>inch (mm)</i>	90 (2286)
Machine Depth <i>inch</i>	28.625 (727)
Machine Height <i>inch</i>	80 (2032)
Shipping Dimensions <i>inch (mm)</i> (WxDxH)	92.5 x 30 x 26 (2350 x 762 x 660)
Motor Power <i>HP</i>	1
Motor Speed <i>rpm</i>	3450
Air Flow <i>cfm</i>	800
Available Voltages	120/60/1 220/60/1 (optional)
Amps	7.8
Fan Diameter <i>inch (mm)</i>	10.6 (269)
Fan Wheel Bore	5/8
Thermal Protection	auto
Timer Interval Selections	2, 4, 8 or 12 hours
Number of Drying Ports	12
dB Reference <i>machine only</i>	between 78 and 82

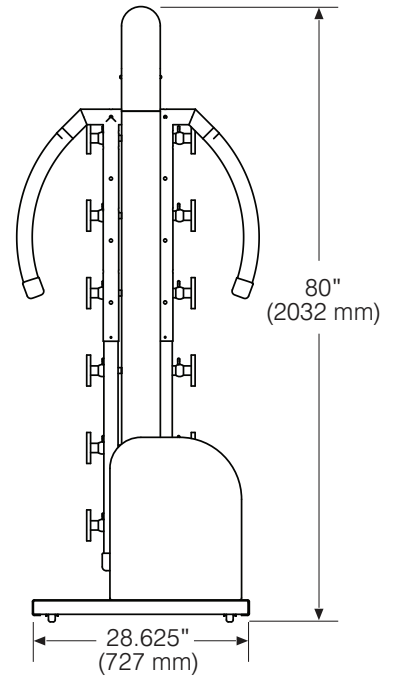

* Product design and specifications are subject to change without notice. For the most current and complete technical specifications, architectural line drawings and warranty information, please visit our website at www.cgilaundry.com.

